

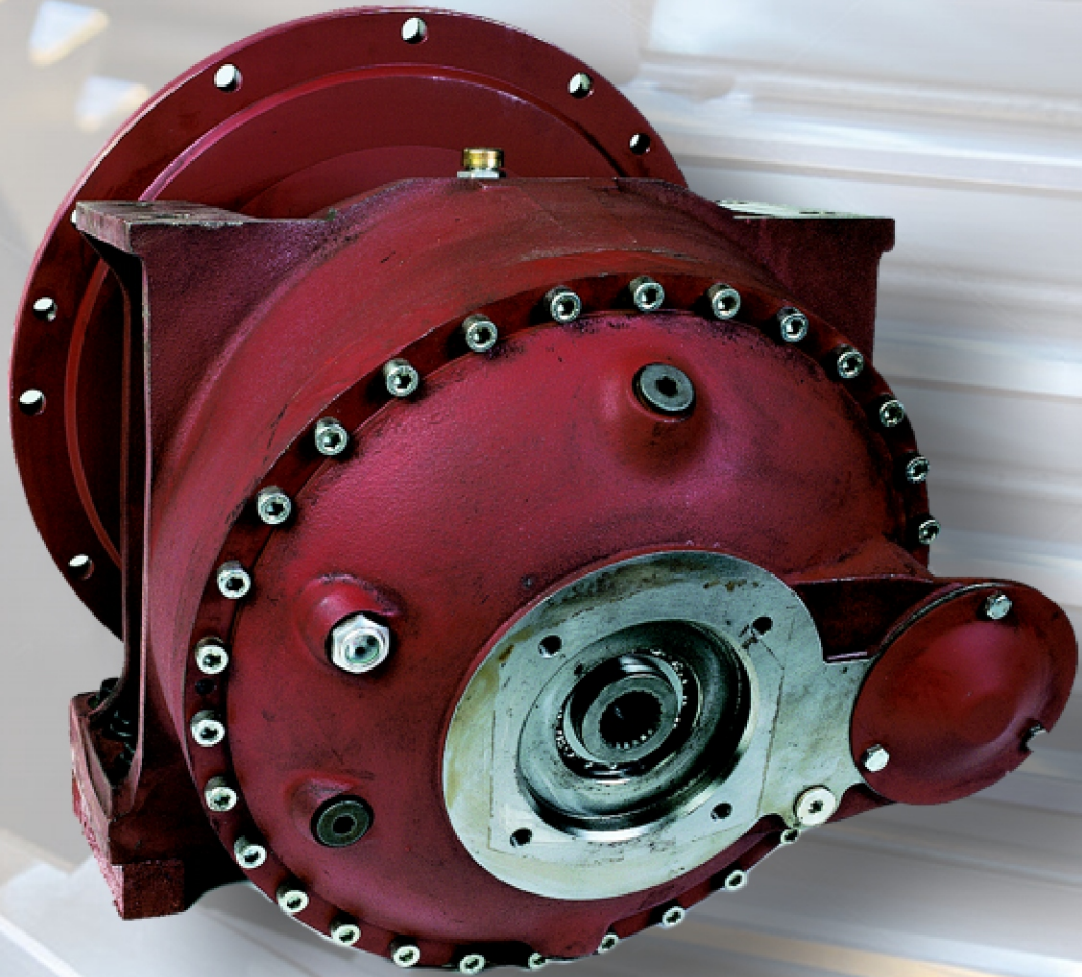

TECHNICAL CATALOGUE



DALCOM[®] s.r.l.

MACHINERY-EQUIPMENT-SPARE PARTS



DALCOM MIXER TRUCK DEVICE

4. Gearbox selection

The concrete mixer gearbox selection must be selected by the mixer designer taking into account a series of parameters including the mixer net volume, drum installation angle, type and slump of concrete, the performance of the hydrostatic transmission, the desired working range of the diesel engine and so on.

The following table shows the typical range of application of dalcom gearboxes as a function of the volume of the mixer:

Please contact the dalcom technical department for a customized selection of the gearbox, by providing the performance data of the mixer with the form attached at the end of this catalogue.

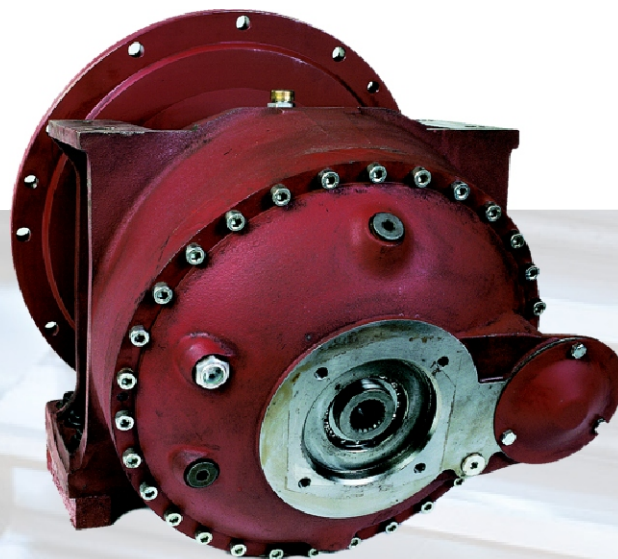

Mixer volume	3 - 5 m ³	6 m ³	8 m ³	10 m ³	12 m ³	16 m ³	20 m ³
INLINE series							
PMB 6.0			√				
PMB 6.5				√			
PMB 7.1					√		
PMB 7.2					√		
PMB 7.8						√	
PMB 8.0						√	
PMB 9.0							√





OK 60.000

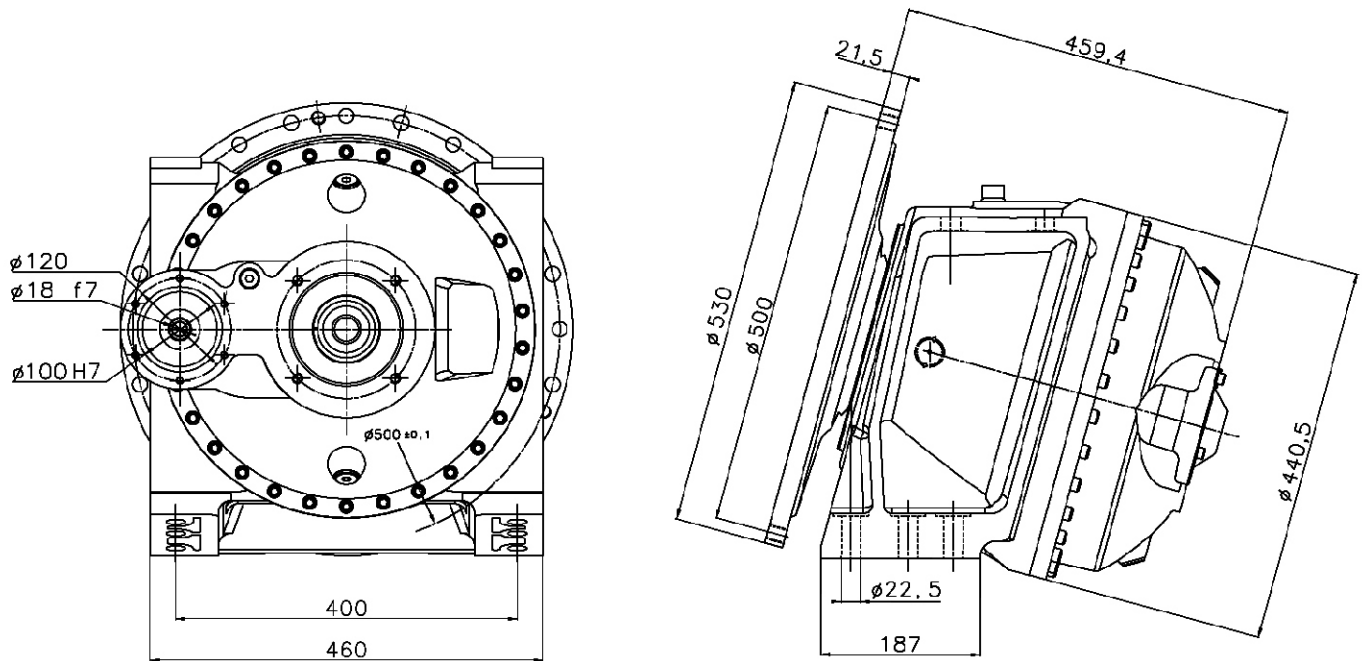

drawing shows version with water pump connection on the left

Gearbox data

Max output torque	$T_{2_{max}}$ [Nm]	60.000
Max input speed	n_{max} [rpm]	2.500
Reduction Ratio	i [·]	100
Max radial load	$F_{R_{max}}$ [kN]	112
Max axial load	$F_{A_{max}}$ [kN]	44
Weight	[kg]	275
Oil quantity	V_{oil} [l]	12
Oil type	—	SAE 85W90 API GL5

Drum installation angle

Up to 6 m ³	°	max 15°
Up to 8 m ³	°	max 13°

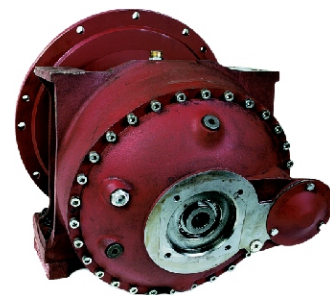



OK 65.000

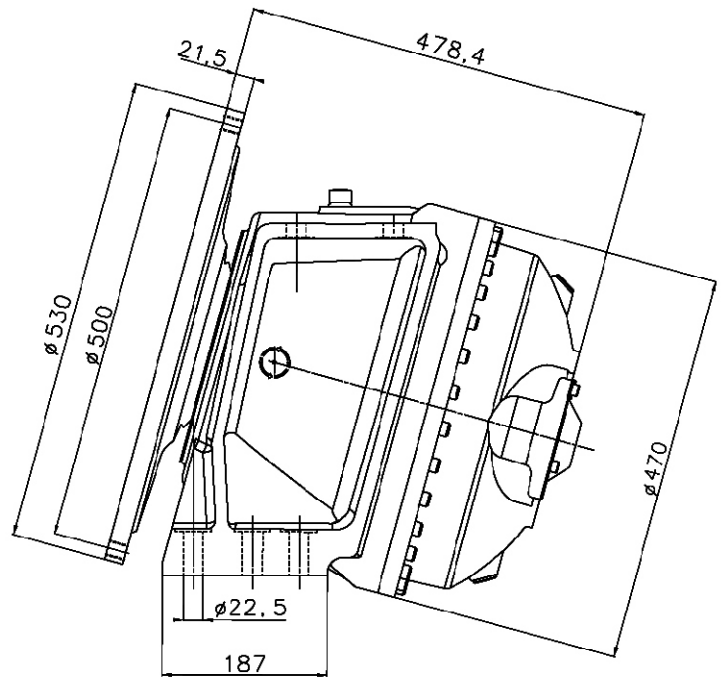
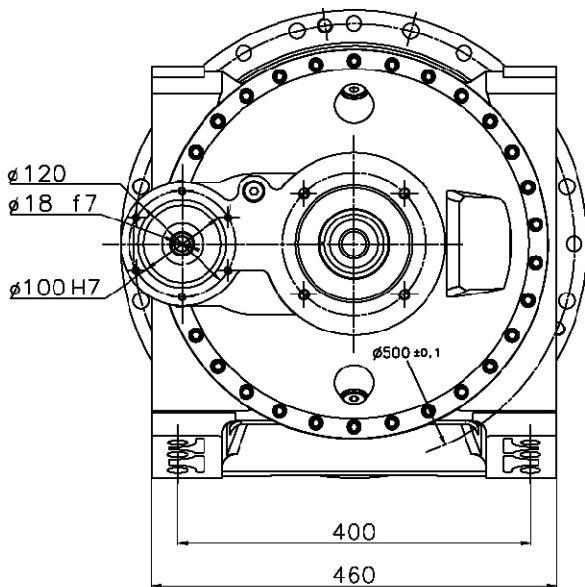

drawing shows version with water pump connection on the left

Gearbox data

Max output torque	$T_{2_{max}}$ [Nm]	65.000
Max input speed	n_{max} [rpm]	2.500
Reduction Ratio	i [:]	120
Max radial load	$F_{R_{max}}$ [kN]	150
Max axial load	$F_{A_{max}}$ [kN]	50
Weight	[kg]	290
Oil quantity	V_{oil} [l]	13
Oil type	—	SAE 85W90 API GL5

Drum installation angle

Up to 6 m ³	°	max 15°
Up to 8 m ³	°	max 13°
Up to 10 m ³	°	max 12°

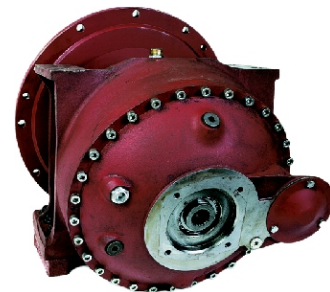



OK 70.000

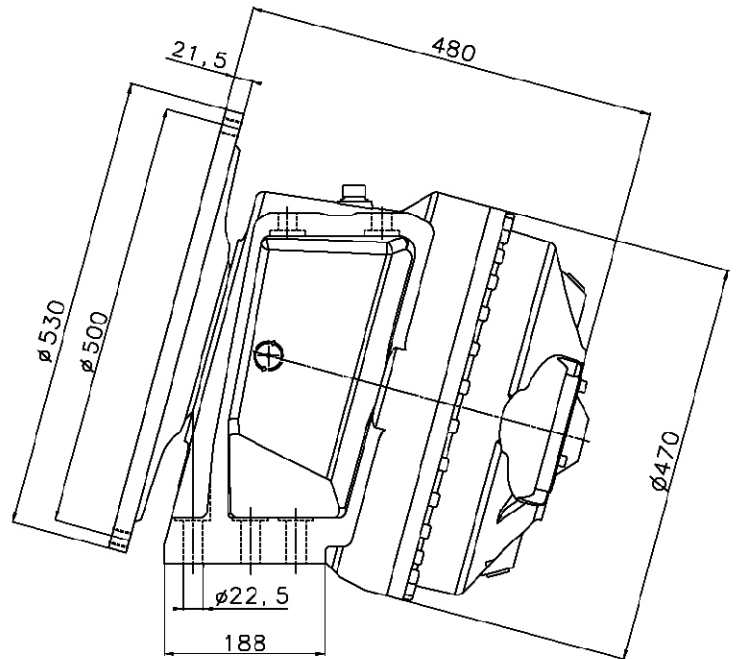
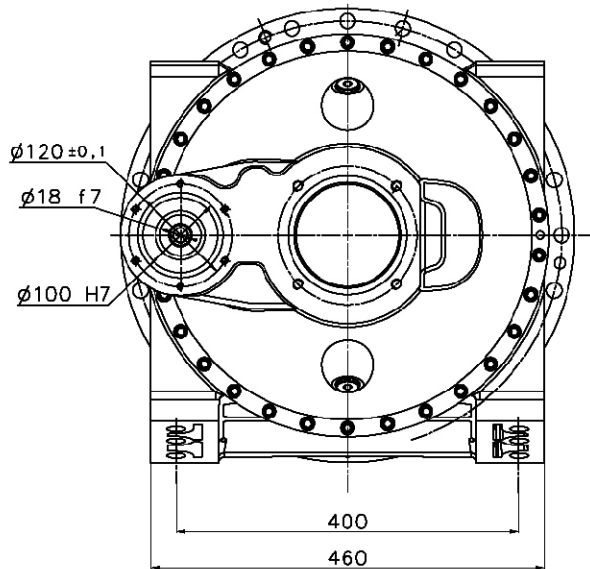

drawing shows version with water pump connection on the left

Gearbox data

Max output torque	$T_{2\max}$ [Nm]	70.000	
Max input speed	n_{\max} [rpm]		
Reduction Ratio	i [:]	120	130
Max radial load	$F_{R\max}$ [kN]	170	
Max axial load	$F_{A\max}$ [kN]	55	
Weight	[kg]	305	
Oil quantity	V_{oil} [l]	14	
Oil type	—	SAE 85W90 API GL5	

Drum installation angle

Up to 6 m ³	°	max 15°
Up to 8 m ³	°	max 13°
Up to 10 m ³	°	max 12°
Up to 12 m ³	°	max 11°

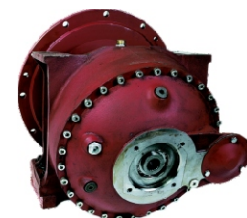



OK 72.000

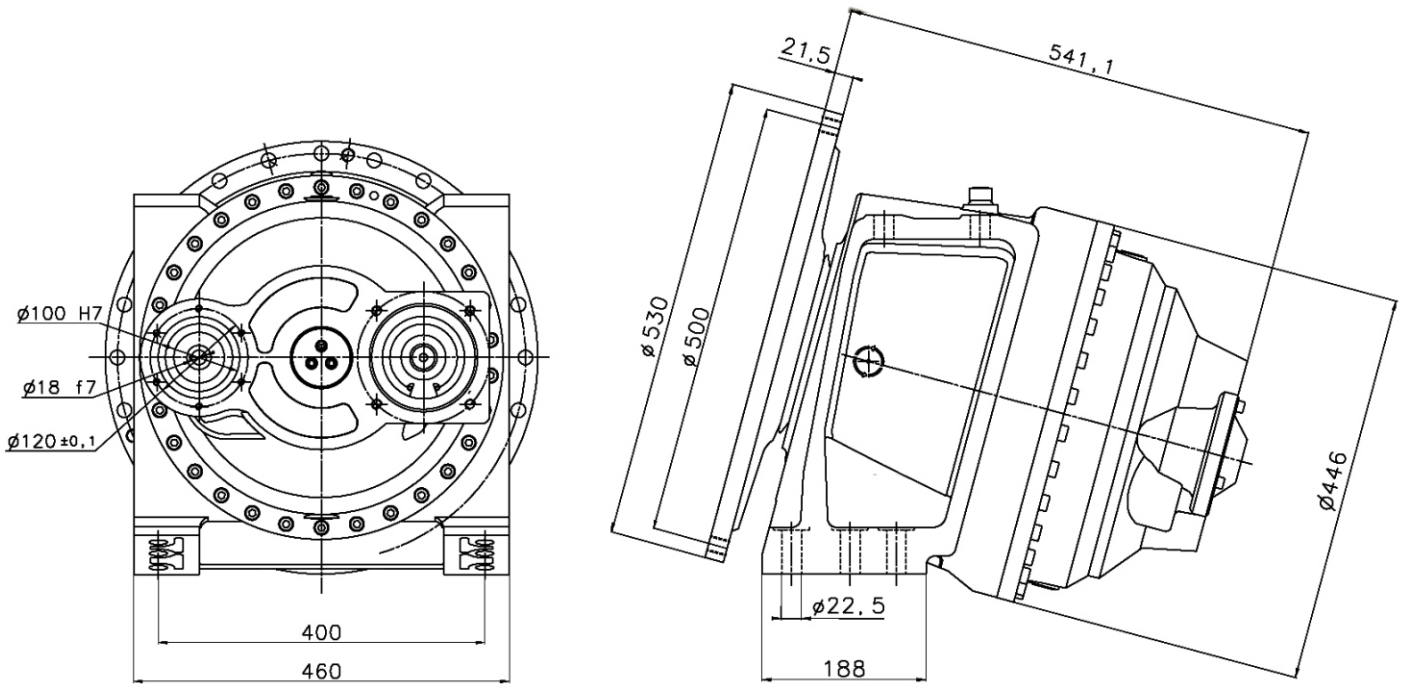

drawing shows version with water pump connection on the left

Gearbox data

Max output torque	$T_{2_{max}}$ [Nm]	72.000	
Max input speed	n_{max} [rpm]	2.500	
Reduction Ratio	i [:]	120	130
Max radial load	$F_{R_{max}}$ [kN]	170	
Max axial load	$F_{A_{max}}$ [kN]	55	
Weight	[kg]	335	
Oil quantity	V_{oil} [l]	15	
Oil type	—	SAE 85W90 API GL5	

Drum installation angle

Up to 6 m ³	°	max 15°
Up to 8 m ³	°	max 13°
Up to 10 m ³	°	max 12°
Up to 12 m ³	°	max 11°

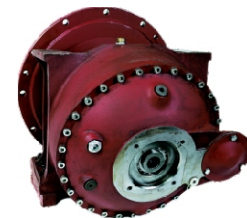



OK 80.000

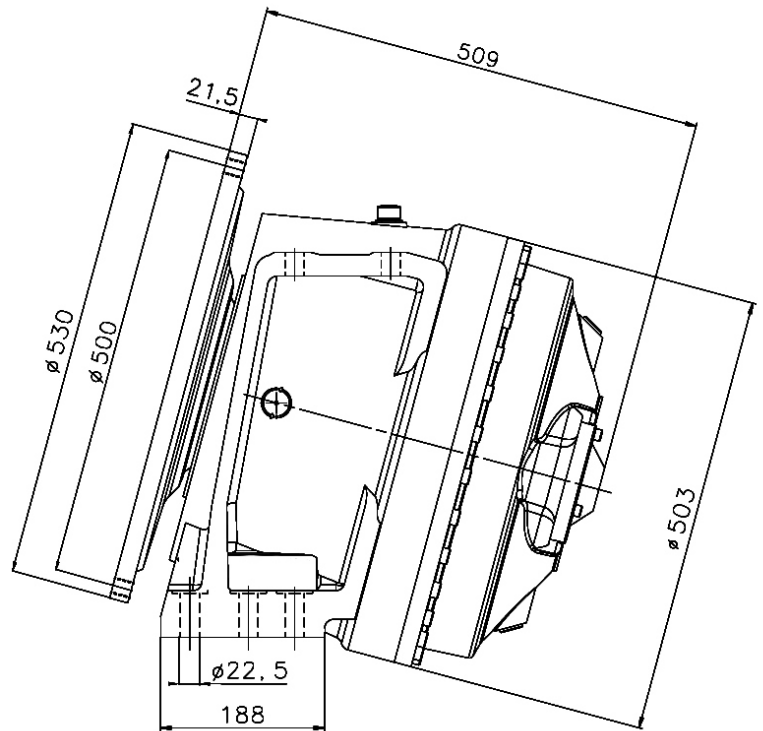
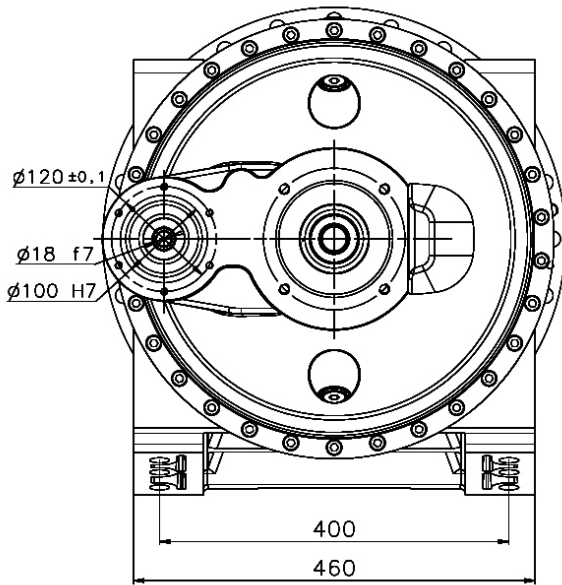

drawing shows version with water pump connection on the left

Gearbox data

Max output torque	$T_{2_{max}}$ [Nm]	80.000	
Max input speed	n_{max} [rpm]	2.800	
Reduction Ratio	i [:]	130	140
Max radial load	$F_{R_{max}}$ [kN]	240	
Max axial load	$F_{A_{max}}$ [kN]	62	
Weight	[kg]	345	
Oil quantity	V_{oil} [l]	16	
Oil type	—	SAE 85W90 API GL5	

Drum installation angle

Up to 7 m ³	°	max 15°
From 8 m ³ to 9 m ³	°	max 13°
Up to 14 m ³	°	max 10°
Up to 16 m ³	°	max 8°

